

奈義町産業振興課

〒708-1392

岡山県勝田郡奈義町豊沢306-1

TEL 0868-36-4114

FAX 0868-36-6780

<http://www.town.nagi.okayama.jp>

kankou@town.nagi.okayama.jp



N

な

A

G

ぎ

I

Art and nature
come together
Nagi-cho



Nagi-cho
Okayama Prefecture



Satomaru-kun
Nagi Town Mascot

Nagi
Visitor Guide



Natural Beauty

P.4~7

Nagi takes its name from the nearby Mt. Nagi. Affording a breathtaking view of the area from the top of the mountain, and serving as a backdrop for daily life in the town below, Mt. Nagi's majestic presence draws eager trekkers all year round.

While in Nagi, there are many ways you can enjoy nature's gifts. Complemented by a rich farming tradition, even within Japan Nagi boasts a reputation for quality produce. Go on, treat yourself!

Eat / Sleep

P.10~11

Art and Culture

P.8~9

index

Local specialties P.12

Getting to Nagi (Map) P.14~15

Reflecting a focus on "lifelong learning", the town has a number of fascinating cultural landmarks, including the Nagi Museum of Contemporary Art.

Mt. Nagi

1,255m (Okayama Prefecture's 4th Tallest Mountain)

Designated as a national park, Mt. Nagi is a showcase for the diversity and beauty found in Japan's changing seasons. Starting with spring's new life, the landscape turns to a brilliantly rich green in summer, which in turn sets alight with autumn colour. Culminating with snow-clad winter vistas, the mountain is a sight at any point of the year.

Natural Beauty

四季折々に咲く数多くの可憐な花

Mountain Flowers Park

The view from the striking, fire-truck red of Tenkūbashi Bridge sets hearts soaring, as the sky melts into the green of the mountains. At its foot, seasonal flowers await those visitors with an eye for their charms. Or, if the fresh air has put you in the mood for a bit of jumping around, water play and green space is available for all to enjoy. The playground is definitely worth a closer look too - themed around the local Sanbutarō Legend - about a friendly giant whose very steps helped to shape Nagi!

☎0868-36-8080

☎0868-36-8008

Days closed:
Day following a public holiday
Monday (in case of a public holiday, the following day is closed instead).
During periods of excessive snow the park may be closed.

Entry: Free Address: Nagi-cho Kouen 591-1
<http://www.town.nagi.okayama.jp/yamanoeki/index.html>



Nagi is the perfect place to appreciate Japan's changing seasons, surrounded by scenery which brings out the best of a country characterized by a very distinct spring, summer, autumn and winter. The two landmarks for this spectacular shift are Mt. Nagi and the enormous Bodaiji Ginkgo Tree, but little hints of life can be found everywhere in a locale known for its harmony between town-life and nature.



Rare Plants and Animals



Shortia uniflora



Scarlet dwarf dragonfly



Sanicula

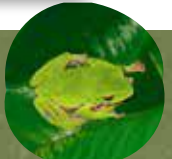

Forest green tree frog



Japanese firefly

Natural Beauty



Nov.

Watching the passage of time for 900 years, the tree stands with an unmatched presence.

Bodaiji Ginkgo Tree

The Bodaiji Ginkgo Tree is nestled up the mountain side of Mt. Nagi National Park, recognized by the national government as a natural monument and a prefecture-wide symbol for Okayama.

According to legend, the influential Buddhist reformer Hōnen planted the tree when he began his initiation as a monk, following his statement that 'learning begins from the roots.'

40m tall and 13m wide, the Bodaiji Ginkgo Tree is one of the Yomiuri Shimbun's Top 100 Famous Trees of Japan for good reason. It is possessed of a storybook presence, all the more alive for the years it has passed.

Inquiries at Nagi Town Office
☎0868-36-4114

Parking capacity: 20 vehicles Bus entry possible
Entry: Free
Address: Nagi-cho Kouen 1535



Amidadou Temple Ginkgo Tree

According to legend, famed Buddhist monk Hōnen used a branch from this 'Parent Tree' to cut a walking stick which would go on to become the Bodaiji Ginkgo Tree. In 2015, DNA testing was done to both plants, with the evidence substantiating the story. Even without knowing this, the Amidadou Tree is undoubtedly a natural miracle, standing for 1,000 years, having reached a height of 13m and a width of 6.8m.

Inquiries at Nagi Town Office
☎0868-36-4114
Address: Nagi-cho Kosaka 518-1



Tenmei Ginkgo Tree

During the Tenmei Era (1781-1789), heavy snow caused one of the Bodaiji Ginkgo Tree's large branches to split in half. The tip of this branch grew into the ground and became what is known as the Tenmei Ginkgo Tree. Like its parent, the tree has reached a massive size - 35.5m tall and 4.2m wide.

Inquiries at Nagi Town Office
☎0868-36-4114
Address: Nagi-cho Kouen 1535

楽園風景 奈義の大自然



Yashiki Waterfall

A water source for surrounding habitation, the waterfall takes its name from the ruins of an estate left behind by a Japanese general during the Warring States era. Delightfully cool and clear, during the warmer parts of the year you will often find people playing in its shallows.

Inquiries at Nagi Town Office
☎0868-36-4114
Parking capacity: 10 vehicles
Entry: Free Address: Nagi-cho Umakuwa

Jyabuchi Waterfall

Jyabuchi waterfall spills at the entrance to the trekking trail for Mt. Nagi - the slow thunder of the water over rocks is a great way to start the trail, made more interesting by being a key setting for the local Sanbutaro Legend. If you're curious about where a half-snake woman (who would give birth to a baby that grows up to be a giant) would live, the waterfall is worth a look.

Inquiries at Nagi Town Office
☎0868-36-4114
Parking capacity: 10 vehicles
Entry: Free Address: Nagi-cho Kouen

Waterfall Temple

Situated quietly in the depths of the mountain forest, this temple is a must-see in the winter months, where snow and ice create an otherworldly remnant from the past.

Inquiries at Nagi Town Office
☎0868-36-4114
Parking capacity: 10 vehicles
Entry: Free Address: Nagi-cho Takimoto





奈義町現代美術館
Nagi Museum of Contemporary Art

Working from a base proposal by famed architect Arata Isozaki, Nagi MOCA is made up of three installations that are both elements of the museum's structure and art works in their own right. Pushing the established conceptions of what it means to experience art, we invite you to explore the manipulation of shape and light, to take a moment to reflect and meditate.

Open: 9:30-17:00 (entry stops at 16:30)
Entry: General entry 700円(500円)
High school student 500円(350円)
Elementary/junior-highschool student 300円(200円)
75 years and over Free
Combined with Bikanri Museum Pass 800円(600円)

Prices quoted in brackets (〇〇円) are for groups with over 20 members.

Days closed:
Day following a public holiday
Monday (in case of a public holiday, the following day is closed instead)
New Years Holiday

Inquiries
☎0868-36-5811
FAX 0868-36-5855
Nagi-cho Toyosawa 441
<http://www.town.nagi.okayama.jp/moca/>
facebook ◆ <http://www.facebook.com/pages/Nagi-MOCA/360771793985466>



- ① 展示室「大地」宮脇愛子 <うつつり>
- ② 展示室「太陽」荒川修作&マドリン・キンス <遍在の場・奈義の龍安寺・建築する身体>
- ③ 展示室「月」岡崎和郎<HISASHIー補遺するもの>

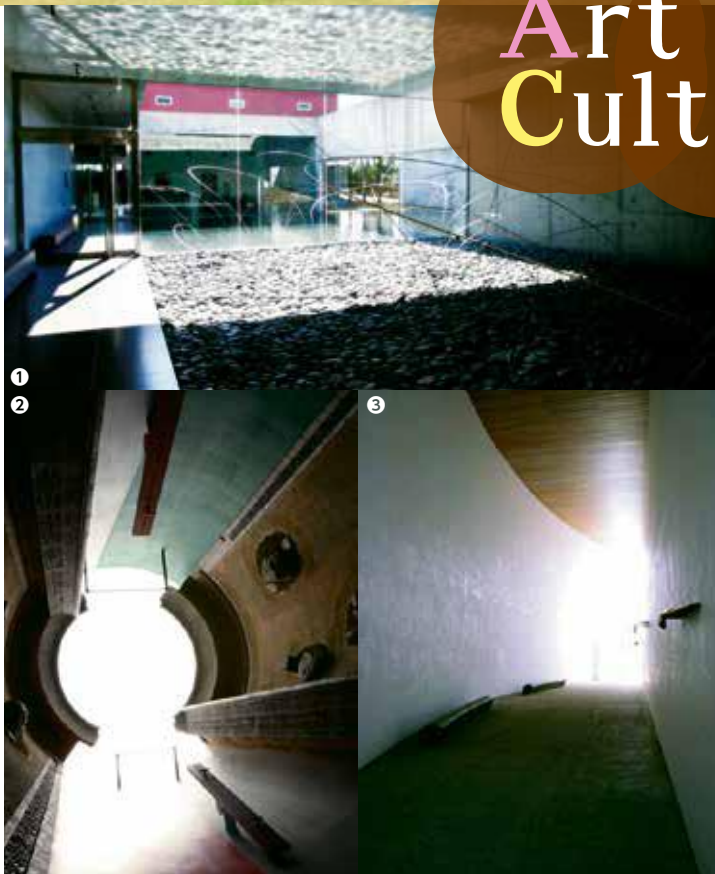

Art and Culture



江戸時代の
上方歌舞伎の舞を現在も
Yokozen Kabuki

Continuing a rich tradition since Edo-era Japan, Nagi's Yokozen Kabuki is recognized as an important intangible folk culture asset of Okayama Prefecture. Distinctive and dramatic, kabuki has long been a Japanese icon. If you're in the area at the right time, seeing a show first-hand at Nagi is an unforgettable experience.

◆ Show Season
Spring Second half of April
Summer Middle of August
Autumn Middle of November
Winter End of February

Kabuki performances take place across the year, with the highlight show taking place in Autumn over two days.

Inquiries
Yokozen Kabuki Preservation Society,
Lifelong Learning Department

☎0868-36-3034
Nagi-cho, Toyosawa 327-1



<http://www.town.nagi.okayama.jp/cms-sypher/higasisakushu/index.html>



身近な情報収集の場
Nagi Library

Nagi's town library is built as part of the Museum of Contemporary Art, and the design sensibility is clear the moment you set foot inside. The light and natural environment outside pours through the windows, and suddenly the idea of powering through that pile of unread books seems a little less crazy.

Used by over 30,000 people a year with 54,000 items available for borrowing, the library is one of the most prominent in the region. Novels, reference and audiovisual materials, braille texts, CDs and DVDs are well furnished. Moreover, reflecting the town's focus on child raising, picture books and information on parenting are a forte. Events are held frequently, ranging from story-time to toy shows.

Open: Tuesday-Thursday 10:00-18:00 Other 9:30
Days closed:
Monday (in case of a public holiday, the following day is closed instead)
New Years Holiday
Towards the end of the month a weekday is taken for maintenance
Inquiries

☎0868-36-5811
FAX 0868-36-5855
Nagi-cho Toyosawa 441
<http://www.town.nagi.okayama.jp/library/index.html>



晴れ晴れグリーンリゾート

那岐山麓 Yama no Eki



Inquiries
☎0868-36-8080
☎0868-36-8008
Nagi-cho Kouen 591-1
Open: 9:30-18:00 (December to April is 9:30-17:00)
Days closed: Monday (in case of a public holiday,
the following day is closed instead)
New Years Holiday
Parking capacity: 60 vehicles, 2 large-size buses
<http://www.town.nagi.okayama.jp/yamaoeki/index.html>
facebook ◆ <http://www.facebook.com/yamaoeki>



The easiest way to experience the heart and soul of Nagi is through "Yama no Eki" (roughly translated to "The Mountain's Station"), a resort spot with cottage facilities and a number of hands-on activities. It is also the best place to get your hands on local specialties, which can be sampled first hand at Yama no Eki's restaurant.

Eating in Nagi-cho

特産物・自然の味わい Nagi Local Specialty Shop

The perfect place to pick up and take away a piece of Nagi, tasty treats made from local ingredients and charming handicrafts.



Black bean ice cream

地元ならではのこだわりの味 Restaurant

Made with love and care only found in local mamas, Yama no Eki's restaurant has a range of mouthwatering dishes that capture the authentic delight of the town. Staff are also more than willing to prepare appetizers and bento boxes to accommodate for a range of budgets.



Kurobuta katsu-curry



My Vegetable Plot Toretoire Bento Box

Rice Bread Bakery

Rice flour chiffon cake

Visit the bakery to sample Yama no Eki's most popular souvenir, chiffon cake made from the popular koshihikari rice. Deliciously springy, the treat gets attention all year from visitors looking to take something home to share as omiyage.



Menu

Exported widely around Japan, Nagi-cho's kurobuta -black pig- is used in a variety of dishes at Yama no Eki.

- My Vegetable Plot Toretoire Bento Box 1,100円
- Kurobuta ginger pork set meal 1,300円
- Kurobuta katsu-don (rice bowl topped with crumbed pork) set with soup and pickled vegetables 1,100円
- Kurobuta katsu-curry with salad 900円

Yama no Eki uses eco-friendly, locally produced koshihikari rice.

Eat / Sleep

Cottage

Wrap up in the heart of nature



Early morning October to February it is not uncommon to look out onto a sea of clouds.

Cottage plan 2LDK

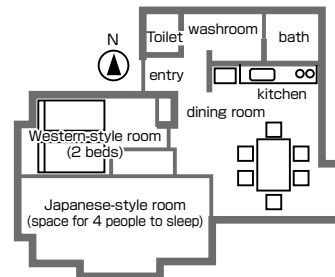

Cottage pricing

	Up to 2 people (one night)	December to March, Sunday to Thursday	3 to 6 people (one night)
General	10,000円	7,000円	1,500円 per person
Students, Seniors over 60	7,000円 <small>※(exempting 20th July to 31st August)</small>	5,000円	1,000円 per person

※As groups of students and groups of seniors over 60 (5 people or more to a cottage) are entitled to receive a discount, please prepare some relevant idea in advance.

Please make bookings at **Yama no Eki**, Nagi-cho Kouen 591-1 TEL0868-36-8080



Kurobuta

Nearly 100% of Okayama's brand-name pork, kurobuta black pig, is raised in Nagi-cho. Kurobuta is fed to exacting standards of quality, with a special mix of barley and wood vinegar, and has come to represent the Japanese extra-special care in agriculture. The resultant pork is known for its tender juiciness, with a fresh flavour that opens into a rich sweetness.



Nagi beef

Nagi-cho's specialty cattle, known simply in Japanese as Nagi-beefu is an exceptionally high-grade wagyu beef that has found its way into fashionable restaurants around Japan. And for good reason: the breeding and care of Nagi-beefu has been refined over many generations, along with the pedigree of calf to cow. Recently Nagi-beefu has been recognised at the Wagyu Beef Prize Show, coming in at 2nd across the whole country.

Local Specialties

Kuromame black beans

Used in a number of popular products (the easiest way you'll be able to try it will be through the kuromame tea, sold in plastic bottles at supermarkets), Nagi's black beans have a distinct taste with many fans - both Japanese and foreigner.



Nagi-cho's particular soil and climate has lent itself to the cultivation of a number of primary specialties. For a long time now, local industries have focused on being competitive as high-end brands. Like much of Japan, agriculture cannot be performed on the scale of larger countries, so a focus on quality is a must - if you get the chance, please try some of the locally sourced food. We're confident you'll be able to tell the difference.



Satoimo

Nagi-cho's soil is rich in volcanic ash, widespread in the outlying region. The high breathability and ventilation of the ground is ideal for growing satoimo (taro), which can be prepared in a number of ways, mostly through simmering in dashi and soy sauce.

Local Specialty Direct Purchase

Nagi-cho Kougen Sansai Mura

Conveniently located on the main road, Nagi-cho Kougen Sansai Mura is the fastest way to get your hands on seasonal local produce. There are also delicious, prepared daily specials on offer.

Open: 9:30-17:30
Days closed: Thursday, New Years Holiday
Address: Nagi-cho Takimoto 476-1

☎0868-36-8341
☎0868-36-8341



Dig up something that was alive 16,000,000 years ago!

Nagi Bikaria Museum

Built to the shape of a shell, the Museum exhibits the now-extinct bicarya (bikaria), a relation to today's sea snail. Fossils from 50 different species are presented across 300 displays, and outside you can dig for actual fossils from 16 million years ago!



Nagi-cho Kaki 1875

☎0868-36-3977

☎0868-36-3977

Opening hours: 9:00-17:00

Entry fee: Normal entry (high school and over) 300円 (200円)

Elementary, middle school entry 150円 (100円)

Younger than elementary school is free

Combined with Nagi MOCA Pass (normal) 800円 (600円)

Days closed: Day following a public holiday

Monday (in case of a public holiday, the following day is closed instead)

New Years Holiday



レクリエーション活動の拠点

Nagi-cho Activity Park

Owing to the large number of young families in the town, Nagi-cho is very active in sports and outdoor activities, with a large park built with input from the community. A baseball pitch, tennis courts, multi-purpose grounds and golf-course are all present and well attended, but it is the thriving skateboard park that likely draws the most surprise. The town takes great pride in its lifelong learning and club activities so there's always something going on.

Opening hours: From 9 o'clock a.m.

Days closed:

Day following a public holiday

Monday (in case of a public holiday, the following day is closed instead)

New Years Holiday

Reservation fees depend based on the facility, so please direct enquiries to: Nagi-cho Kaiyou Center Nagi-cho Kaki 1074

☎0868-36-3300

☎0868-36-6440



Facilities: Multi-purpose ground, baseball pitch, tennis courts (6), gymnasium, pool, 27-hole golf course, skateboard park, training gym

SDF Events

Japanese Self-Defense Force, Camp Nihon-bara

Visits to the base, observation of the tanks and helicopters displayed outside, and entry to the merchandise store are possible by contacting the Public Relations Office.

All queries to the Public Relations Office

☎0868-36-5151

July

●Nouryou Inspection

September

●Memorial Ceremony (training exhibition, tank-ride experience)



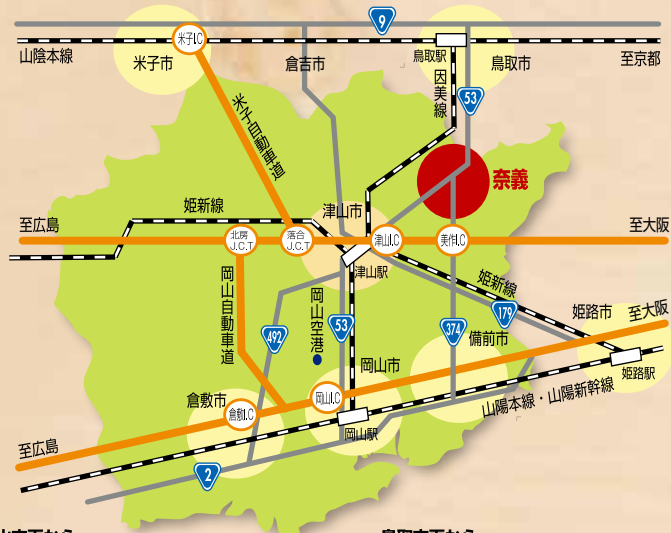

岡山方面から		鳥取方面から	
岡山	JR 1時間30分 車 R53 1時間30分	鳥取	JR 1時間40分 車 R53 奈良まで1時間
津山	バス 40分 車 30分	津山	バス 40分 車 30分
大阪方面から			
美作	中田自動車道 2時間 車 20分	奈良	

● 奈良町施設一覧表

名称	市外局番 0868		住所	時間	休館日等	他
	電話	FAX				
那岐山麓山の駅	36-8080	36-8008	高円591-1	4月~11月/9:30~18:00 12月~3月/9:30~17:00	月曜日(祝日の場合は翌日)	食事 米粉パン コテージ(宿泊)
山野草公園	36-8080	36-8008	高円591-1	4月~11月/9:30~18:00 12月~3月/9:30~17:00	月曜日(祝日の場合は翌日) ※観望時間により予告なく休館することがあります。	山野草約20種類
奈良町現代美術館	36-5811	36-5855	豊沢441	9:30~17:00 入館は16:30まで	月曜日、祝日の翌日、年末年始	3つの空間的作品 の美術館
奈良町立図書館	36-5811	36-5855	豊沢441	火・木 10:00~18:00 他 9:30~17:00	月曜日、祝日の翌日、年末年始 月末近くの平日1日は整理日	蔵書8万冊
なぎピカリアミュージアム	36-3977	36-3977	柿1875	9:00~17:00	月曜日、祝日の翌日、年末年始	化石発掘体験可
奈良町農産物等直売施設 なぎ高原山彩村	36-8341	36-8341	滝本476-1	9:30~17:30	木曜日、年末年始	新鮮野菜+加工品 惣菜直売
奈良町B&G海洋センター	36-3300	36-6440	柿1074	8:30~22:00	月曜日、祝日の翌日、年末年始	総合運動公園
奈良町役場産業振興課	36-4114	36-6780	豊沢306-1	8:30~17:15	土、日、祝日、年末年始	観光担当課

奈良町施設情報

宿泊施設情報

名称	市外局番 0868		住所
	電話	FAX	
那岐山麓山の駅コテージ	36-8080	36-8008	高円591-1
民宿 さわ	36-3117	36-3196	豊沢263-10
那岐旅館	36-3130	36-3130	久常243-2
那岐山荘	36-8041	36-8124	高円1124
民宿 なぎ	20-1151	36-5687	西原350-9

交通関係情報

名称	市外局番 0868		住所
	電話	FAX	
豊沢交通株式会社 (バス・タクシー)	36-7355	36-7354	高円1561-2
中鉄北部バス株式会社	27-2827	27-1100	津山市東一宮 1234-1

M A P & 施設情報



施設情報

